

**Interrupor automático miniatura**  
**Miniature Circuit Breaker**



Instrucciones de montaje

Installation Instructions

**NOARK**

ZB1N/B1A/B1H201208NA





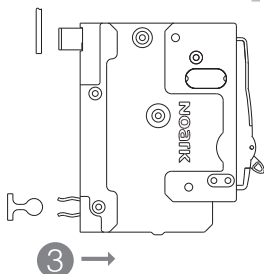
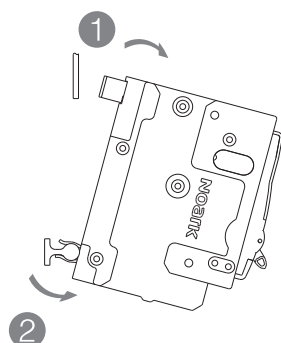
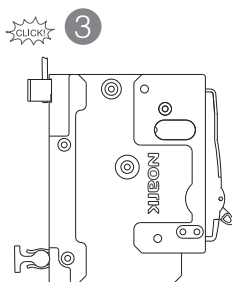
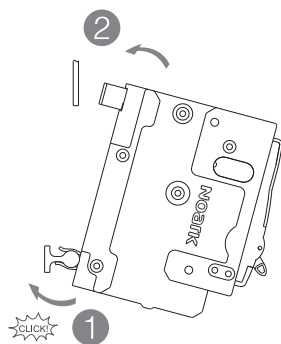

**ADVERTENCIA**

**NO INTENTAR A INSTALAR EL INTERRUPTOR O HACER MANTENIMIENTO CUANDO ESTA ENERGIZADO. CONTACTO CON EQUIPO ENERGIZADO PUEDE CAUSAR FALLECIMIENTO, DAÑO GRAVE A PERSONA, O DETERIORO SUBSTANCIAL A BIENES. SIEMPRE VERIFICAR QUE EL VOLTAJE NO ES APLICADO ANTES DE HACER EL TRABAJO, Y SEGUIR PROCEDIMIENTOS DE SEGURIDAD GENERALMENTE ACEPTADOS.**

**NOARK NO ES RESPONSABLE DE APLICACION E INSTALACION NO ADECUADA DEL INTERRUPTOR.**



	 Z2
 Cable 1 Wire 1	$a \geq 6\text{mm}$ $b \geq 2\text{mm}$
 Cable 2 Wire 2	14-4AWG (2.5-25mm <sup>2</sup> )
	31lb.in(3.5Nm)

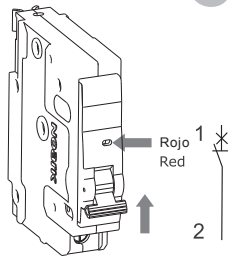
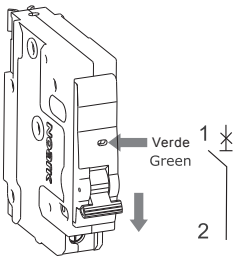
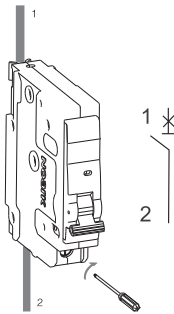

**Capacidad Interruptiva: 10kA**  
**Tensión Nominal: 1/2P: 120/240Vca; 3P: 240Vca**  
**Corriente Nominal: 10-60A**

**Interrupting capacity: 10kA**  
**Rated voltage: 1/2P: 120/240Vac; 3P: 240Vac**  
**Rated amp: 10-60A**

# NOARK



Printed with environment-friendly paper.  
 Impreso con papel beneficioso a medio ambiente.  
 Copyright Noark. All Rights Reserved.  
 Derechos del autor Noark. Todos los derechos reservados.

[www.noark-electric.com](http://www.noark-electric.com)

11/2014